

Technical Data Sheet Rev 06-250731

50W PoE to USB-C PD Power Adapter, 802.3 BT Compliant

Model Number: CG-PoE-CESBT

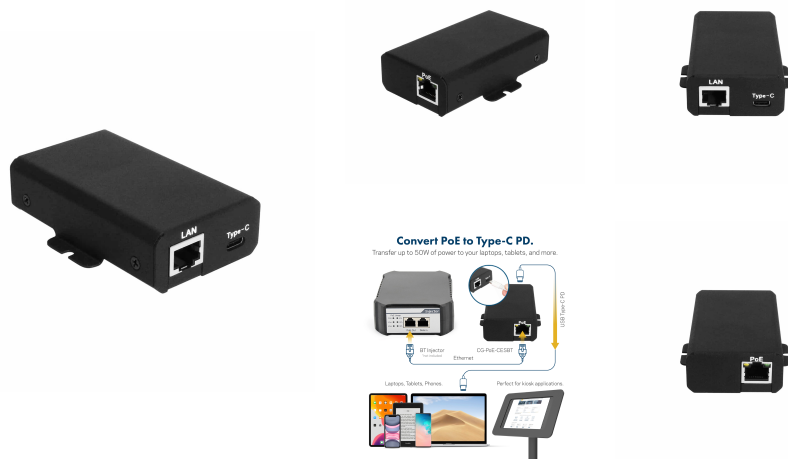

Features

- Indoor PoE rated networking converter, designed to convert PoE to Type-C PD.
- Delivers up to 50W with variable output (5V, 9V, 12V, 15V, 20V) to meet the needs of various USB-C devices.
- Supports data speeds of 10/100/1000 Mbps for high-performance networking.
- Extended Distance Support: Operates up to 100 meters away from a PoE switch or injector over Cat5/5e/6 cabling.
- **Poe Injector not included - Customer Supplied**

Package Contents

- Adapter

Specifications

OVERVIEW

Model No	CG-PoE-CESBT	Product Type	POE Charger
Compliance	IEEE 802.3 bt	UPC	045079162198
Country of Origin	China	LED indicators	None or N/A
Electrical Protections	4kV Contact, 8kV Air		

PHYSICAL

Ship Weight (lbs)	0.31 lbs	Ship Weight (kg)	0.14 kg
Item Weight	0.313 lbs	Length	3.54331 inches
Width	2.52835 inches	Height	0.94488 inches
Color	Black	Mountable	Surface / Wall Mount

Specifications Cont.

CONNECTIONS

Upstream Port Type	Type C
Downstream Port Count	1
Downstream Port Type	RJ-45
Works as Standalone Charger	Y - Can be used without Host

POWER

Input Voltage	44V ~ 57V
Power Connector	PoE / RJ45
Max Per Port Draw	5V Profile : 4.93V @ 3.175A
Supported Charge Protocols	AFC BC 1.2 DCP FCP PD QC 3.0 / 2.0 Samsung SCP
Charging Details	5V/3.4A, 9V/3A, 12V/3A, 15V/3A, 20V/2.5A

ENVIRONMENTAL

Operating Temperature	10C ~ 60C
Storage Temperature	-20C ~ 70C
Operating Humidity	15 ~ 85% RH

OS SUPPORT

Supported Operating Systems	OS independent - No software or drivers required
-----------------------------	--

WARRANTY

Warranty Period	1 Year
-----------------	--------

PRODUCT URL

Product Page	https://www.coolgear.com/product/poe-to-type-c-pd-splitter-bt
--------------	---

USB CHARGING & CONNECTIVITY EXPERTS

We Speak Your Speak



When you reach out to Coolgear support, you'll find yourself in the hands of a solution-oriented and knowledgeable expert ready to answer whatever question you throw at them. Go ahead, test us.

[Visit Support](#)